

Bearing & distance
down Lechawassin

1	N	32	W	18
2	North			46
3	N	18	E	30
4	N	32	E	64
5	N	6	E	25
6	N	40	E	4

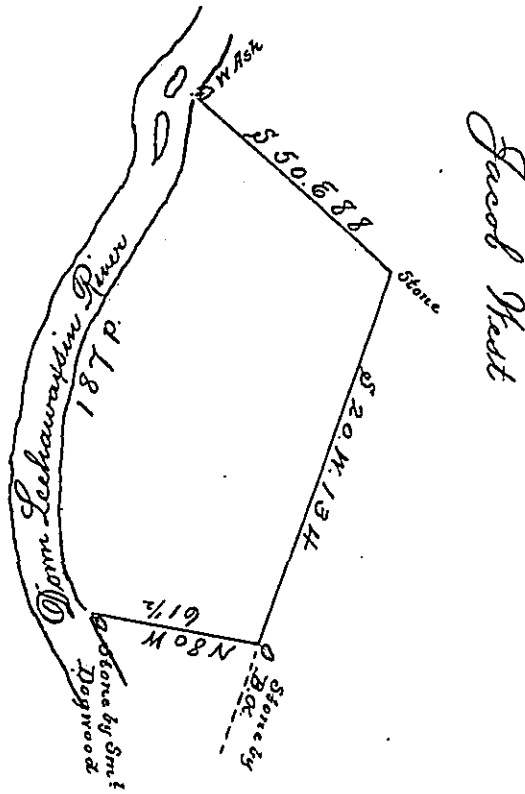

By Virtue of a Warrant dated the 1st July 1784. Surveyed the 4th September 1784 to James Vanaken Esq^r the above described tract of Land Situate on the South side of Lechawassin River opposite to two small Islands below the falls in Northampton County Containing Forty seven Acres ^{seven} sixty perches and the allowance of Six p Cent $\frac{1}{2}$ ^a

p Geo: Palmer

To John Lukens Esquire }
Surveyor General }

IN TESTIMONY that the above is a copy of the original remaining on file in the Department of Internal Affairs of Pennsylvania, made conformably to an Act of Assembly approved the 16th day of February, 1833, I have hereunto set my Hand and caused the Seal of said Department to be affixed at Harrisburg, this Seventh day of March 1899.

James W. Fetta
Secretary of Internal Affairs.